

Made with a light fingering weight green wool, this hat is perfect for keeping out chills. Both the green wool, and the gray accent are re-purposed from thrift store sweaters. The gray yarn is very light lace weight and did not appreciably impact the gauge. Look for a sweater with a gauge of 7-10 stitches per inch to get the proper weight yarn.



Yarn—About 300 yards of fingering weight yarn (16 wraps per inch) from an unraveled sweater
A good commercial substitute would be 2 balls of Knit Picks Palette

Gauge—15 stitches and 22 rows per 2” in cable pattern

Materials—Size 2 16” circular and double pointed needles *or size needed to get gauge*

Sizes—19.25”(20.5”, 22”)

While this hat should be snug, be warned the lack of purls make this less stretchy than similarly cabled hats, so if in doubt, make it slightly larger than you feel is necessary.

Brim

With circular needles and method of choice, CO 98(108, 118) stitches. Place marker and join in round, being careful not to twist. Work in K1P1 rib for 1 inch.

Body

Begin chart A

Work 13 (14, 15) repeats of chart each round until hat is 5”(5.5”, 5.5”) long from beginning, or desired length, ending after row 8 of chart.

Crown Decreases

Begin chart B

Work 13 (14, 15) repeats of chart each round until end of chart, changing to double pointed needles when necessary. 13 (14, 15) sts remain.

Next row—K2TOG all sts, ending with a K1 for small and large sizes.

Break yarn and draw through remaining live sts. Weave in ends. Wear reclaimed hat proudly!

Pattern and charts are intellectual property of thriftdknits.wordpress.com. Unlimited noncommercial use allowed. Permission required for commercial use.

Chart Key and Stitch Explanation

The cable decreases take a bit of finagling on the needles, but the uninterrupted cables are worth the work.

- Cable 4 Front Decrease—Transfer 2 sts to cable needle held to front of work. K2TOG next 2 sts. K2 sts off of cable needle
- Cable 4 Back Decrease—Transfer 2 sts to cable needle held behind work. K2 sts. K2TOG off cable needle
- Cable 3 Back Decrease—Transfer 1 st to cable needle held behind work. K2TOG. K1 off cable needle.
- Cable 3 Front Decrease—Transfer 2 sts to cable needle held in front of work. K1 st. K2TOG off cable needle.

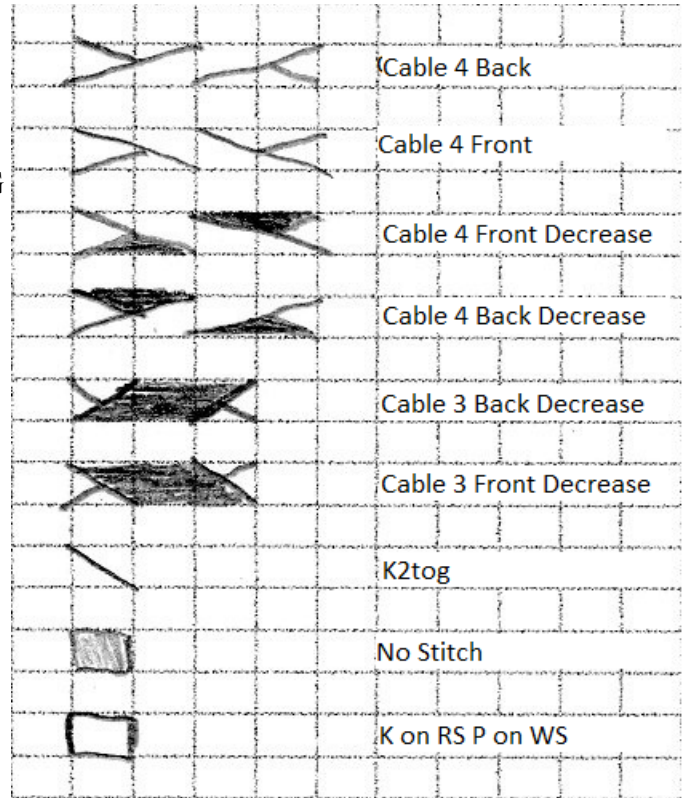

Chart A—Body of hat

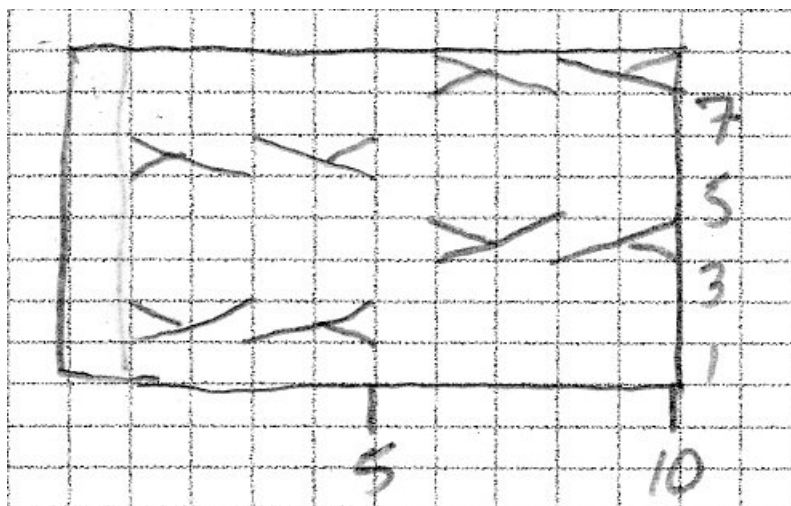
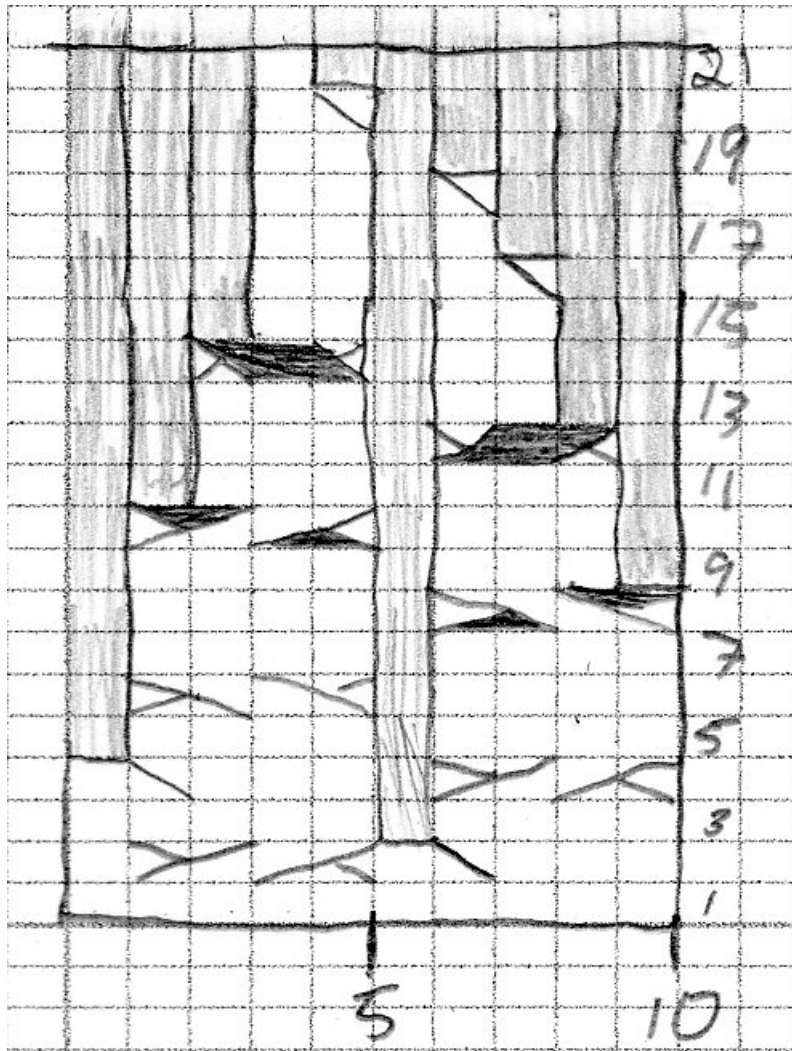

Chart B—Crown Decreases



Pattern and charts are intellectual property of thriftdknits.wordpress.com. Unlimited noncommercial use allowed. Permission required for commercial use.